

MINUTE ITEM

PRC 5677

This Calendar Item No. C20
was added to the Minute Item
No. 20 of the Lands
Committee on June 5, 1979.
to 0 items 6-5-79
meeting.

CALENDAR ITEM

C20.

5/79
W 21973
Maricle

GENERAL PERMIT - RECREATIONAL USE

APPLICANT: Twin River Farms, A Partnership
c/o A. L. Hilleland
752 Hilton Road
Walnut Creek, California 94595

AREA, TYPE LAND AND LOCATION:
A 0.06 acre (2,620 square feet) tide and
submerged land, San Joaquin River, Webb
Tract, Contra Costa County.

LAND USE: Double uncovered berth.

TERMS OF PROPOSED PERMIT:

Initial period: 25 years from June 1,
1979.

Surety bond: \$5,000.

Public liability insurance: Combined single
limit coverage of \$600,000.

CONSIDERATION: \$50 per annum, with the State reserving
the right to fix a different rental on
each fifth anniversary of the permit.

BASIS FOR CONSIDERATION:

Fixed rental for this type of permit.

2 Cal. Adm. Code 2005.

PREREQUISITE TERMS, FEES AND EXPENSES:

Applicant is owner of upland.

Filing fee has been received.

STATUTORY AND OTHER REFERENCES:

A. P.R.C.: Div. 6, Parts 1 & 2.

B. Cal. Adm. Code: Title 2, Div. 3.

OTHER PERTINENT INFORMATION:

1. This project is exempt from CEQA because
it qualifies as a Class 3 exemption;
less than 3,000 square feet.

Authority: 2 Cal. Adm. Code 2907.

A 10

S 7

CALENDAR PAGE	78
MINUTE PAGE	872

CALENDAR ITEM NO. 620 (CONTD)

2. This project does not qualify for a recreational pier permit in that the upland is not used solely for a single family residence.
3. This project is situated on State land identified as possessing significant environmental values pursuant to P.R.C. 6370.1, and is classified in a use category, Class "B", which authorizes Limited Use.

Staff review indicates that there will be no significant effect upon the identified environmental values. This is a proposed facility for which no adverse comments have been received.

APPROVALS OBTAINED:

United States Army Corps of Engineers,
Reclamation District No. 2026.

FURTHER APPROVALS REQUIRED:

Building Permit, Contra Costa County.

EXHIBITS:

A. Land Description (Plat). B. Location Map.

IT IS RECOMMENDED THAT THE COMMISSION:

1. DETERMINE THAT AN EIR HAS NOT BEEN PREPARED FOR THIS ACTIVITY AS SUCH REPORT IS NOT REQUIRED UNDER THE PROVISIONS OF P.R.C. 21085, 14 CAL. ADM. CODE 15100 ET SEQ., AND 2 CAL. ADM. CODE 2907.
2. FIND THAT GRANTING OF THE PERMIT WILL HAVE NO SIGNIFICANT EFFECT UPON THE ENVIRONMENTAL CHARACTERISTICS IDENTIFIED PURSUANT TO SECTION 6370.1, OF THE P.R.C.
3. AUTHORIZE ISSUANCE TO TWIN RIVER FARMS, A PARTNERSHIP OF A 25-YEAR GENERAL PERMIT - RECREATIONAL USE FROM JUNE 1, 1979; IN CONSIDERATION OF ANNUAL RENT IN THE AMOUNT OF \$50, WITH THE STATE RESERVING THE RIGHT TO FIX A DIFFERENT RENTAL ON EACH FIFTH ANNIVERSARY OF THE PERMIT; PROVISION OF A \$5,000 SURETY BOND; PROVISION OF PUBLIC LIABILITY INSURANCE, COMBINED SINGLE LIMIT COVERAGE OF \$600,000; FOR THE CONSTRUCTION AND MAINTENANCE OF A DOUBLE UNCOVERED BERTH FOR RECREATION AND ALTERNATE ACCESS PURPOSES ON THE LAND DESCRIBED ON EXHIBIT "A" ATTACHED AND BY REFERENCE MADE A PART HEREOF.

No. 6693

APPROX. 4620' TO P/L
BEARING N 9° 16' W
ALONG PERIMETER OF ISLAND

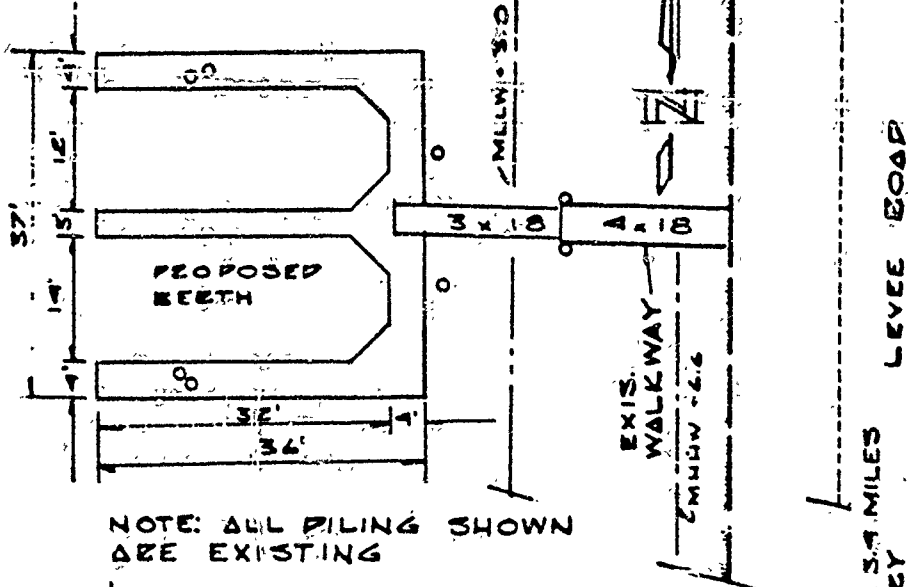

NOTE: ALL PILING SHOWN
ARE EXISTING

APPROX. 11320' TO P/L
BEARING S 82° 33' W
ALONG LEVEE ROAD

PLAN
SCALE @ 1" = 20'

PR. PROP. OWNERS

MONTZEL TRUST CO.
1057 FORT ST.
VICTORIA, B.C. CANADA
PARCEL 026-070-006

D.J. PICKERELL
P.O. BOX 384
BURLINGAME CA.
94010

ALL SOUNDINGS ARE
MEASURED IN FEET
FROM MILLW + 3.0 C.O.P.E
DATUM

MATERIALS
SKIDGARD DECK
GALV. HARDWARE
STYROFOAM FLOATS
3 x 10 P.F. CONST.

SAN JOAQUIN RIVER

FLOOD
E.E.E.

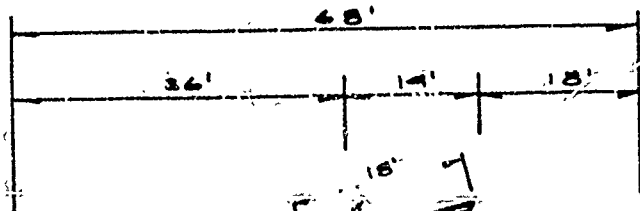

CROSS SECTION
SCALE @ 1" = 20'

MILLW + 6.6
MILLW + 3.0

EXIST. PILING TYP.

3/4" WATER
1" ELEC.

MUD LINE

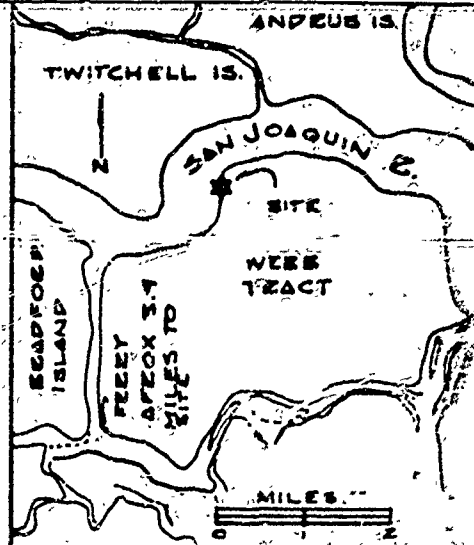
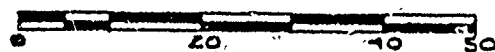

FROM CALIF. RES. AGENCY
MAP SEP. 1974

SACTO. CO. CONTRA COSTA CO.

SAN JOAQUIN R.

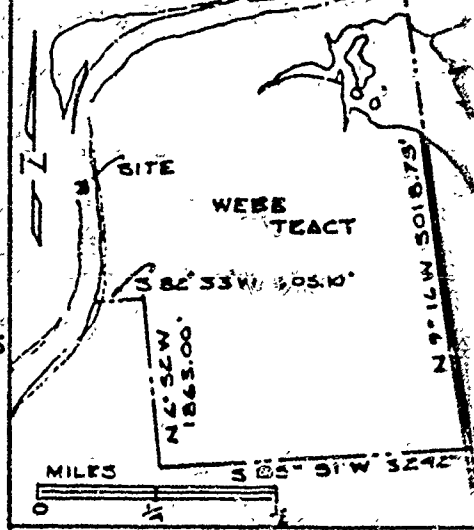

FROM USGS 7.5' SERIES
BOULDER JERSEY IS. QUAD
1952

APPLICANT: MR. D.L.
HILLELAND, 752 HILTON
ROAD, WALNUT CREEK, CA.
94598

SITE: NORTHWEST
CORNER OF WEBB TRACT
ASSESSORS PARCEL
NO 026-070-001
CONTRA COSTA CO.

DR. ANDERSON-WIETH
P.O. BOX 208
BETHEL ISLAND, CA.
94511

9-78
CALENDAR PAGE
MINUTE PAGE

80

87

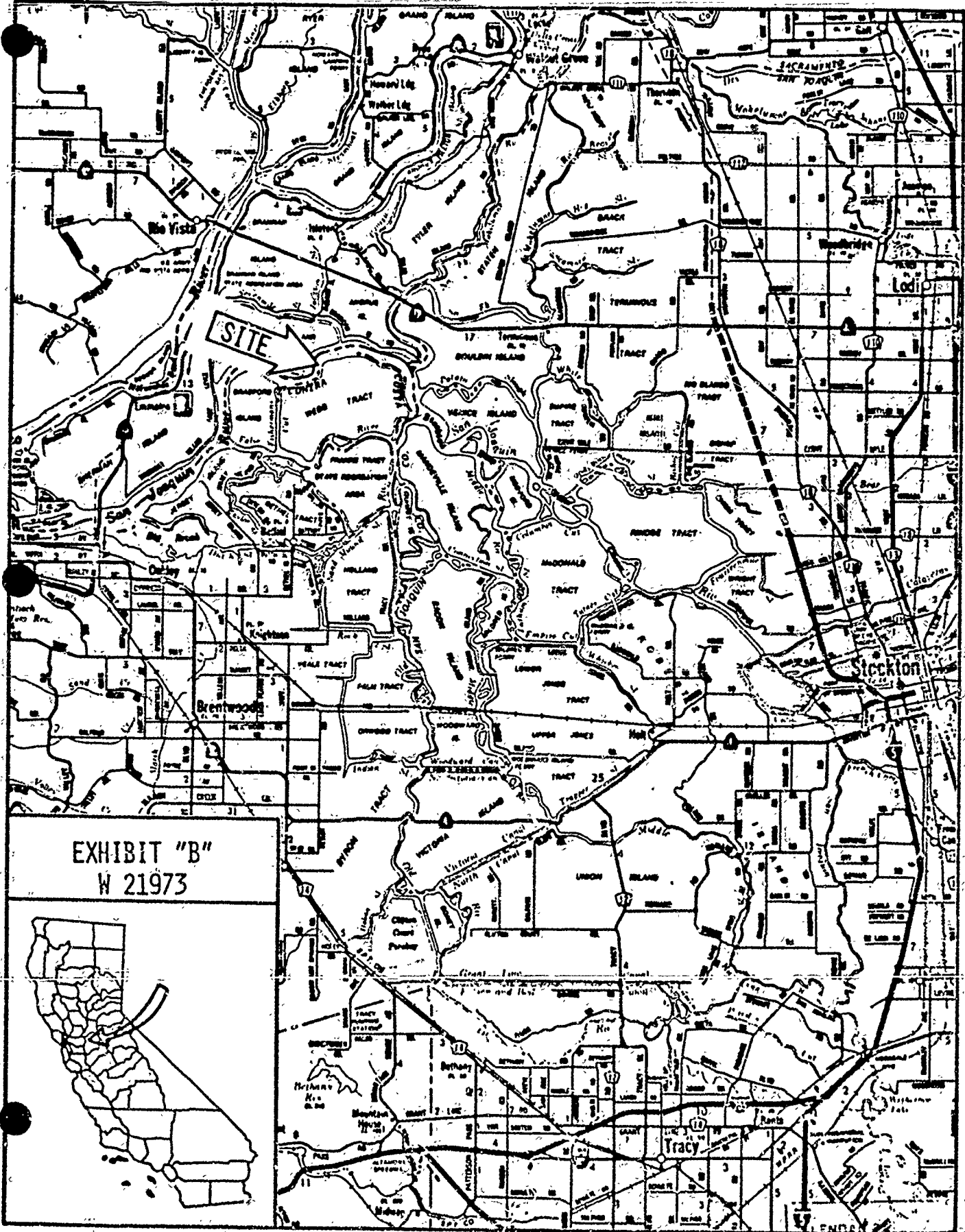

EXHIBIT "B"
W 21973

