

MINUTE ITEM

This Calendar Item No. C14
was approved by the Board
No. 14
General Permit No. 2 CALENDAR ITEM
to 0 on 4/26/79
meeting.

C14.

4/79
W 21966
De La Cruz
PRC 5658

GENERAL PERMIT - PUBLIC AGENCY USE

APPLICANT: California Department of Transportation
1120 N Street
Sacramento, California 95814

AREA, TYPE LAND AND LOCATION: A 0.036 area parcel of submerged land in
the Sacramento River at the City of Princeton.

LAND USE: Realignment of Princeton Ferry Road.

TERMS OF PROPOSED PERMIT:
Special: Indefinite period from May 1, 1979.

CONSIDERATION: As specified by Section 101.5, Streets
and Highways Code.

PREREQUISITE TERMS, FEES AND EXPENSES:
Applicant is owner of upland.

- STATUTORY AND OTHER REFERENCES:
- A. P.R.C.: Div. 6, Parts 1 & 2,
 - B. Cal. Adm. Code: Title 2, Div. 3.
 - C. Streets and Highways Code Section 101.5.

- OTHER PERTINENT INFORMATION:
1. The annual rental value of the site is estimated to be \$100.
 2. A negative declaration was prepared by the Department of Transportation pursuant to CEQA and implementing regulations. A notice of determination has been received.
 3. This project is situated on State land identified as possessing significant environmental values pursuant to P.R.C 6370.1, and is classified in a use category, Class B, which authorizes Limited Use.

3

S 1

CALENDAR PAGE	<u>052</u>
MINUTE PAGE	<u>697</u>

CALENDAR ITEM NO. C14 (CONTD)

Staff has coordinated this project with those agencies and organizations who nominated the site as containing significant environmental values. They have found this project to be compatible with their nomination.

EXHIBITS: A. 101.5 Plat. R. Location Map.
 C. Negative Declaration. D. Notice of Determination

IT IS RECOMMENDED THAT THE COMMISSION:

1. DETERMINE THAT AN FIR HAS NOT BEEN PREPARED FOR THIS PROJECT BUT THAT A NEGATIVE DECLARATION HAS BEEN PREPARED BY THE CALIFORNIA DEPARTMENT OF TRANSPORTATION ON DECEMBER 29, 1977.
2. CERTIFY THAT THE COMMISSION HAS REVIEWED AND CONSIDERED THE INFORMATION CONTAINED IN THE NEGATIVE DECLARATION.
3. DETERMINE THAT THE PROJECT WILL NOT HAVE A SIGNIFICANT EFFECT ON THE ENVIRONMENT.
4. FIND THAT GRANTING OF THE PERMIT WILL HAVE NO SIGNIFICANT EFFECT UPON ENVIRONMENTAL CHARACTERISTICS IDENTIFIED PURSUANT TO SECTION 6370.1, OF THE P.R.C.
5. AUTHORIZE ISSUANCE TO THE CALIFORNIA DEPARTMENT OF TRANSPORTATION PURSUANT TO SECTION 101.5 OF THE STREETS AND HIGHWAYS CODE, OF A GENERAL PERMIT - PUBLIC AGENCY USE FOR AN INDEFINITE TERM FROM MAY 1, 1979; AND THE APPROVAL FOR THE EXECUTION OF A PLAT PURSUANT TO THE STREETS AND HIGHWAYS CODE, IN CONSIDERATION OF THE MONETARY VALUE OF THE RIGHT-OF-WAY TO BE DEPOSITED IN THE GENERAL FUND FOR CREDIT TO THE RESOURCES PROTECTION ACCOUNT, FOR THE REALIGNMENT OF PRINCETON FERRY ROAD AS DELINEATED ON EXHIBIT "A" ATTACHED AND BY REFERENCE MADE A PART HEREOF.

CALENDAR PAGE	053
MINUTE PAGE	628

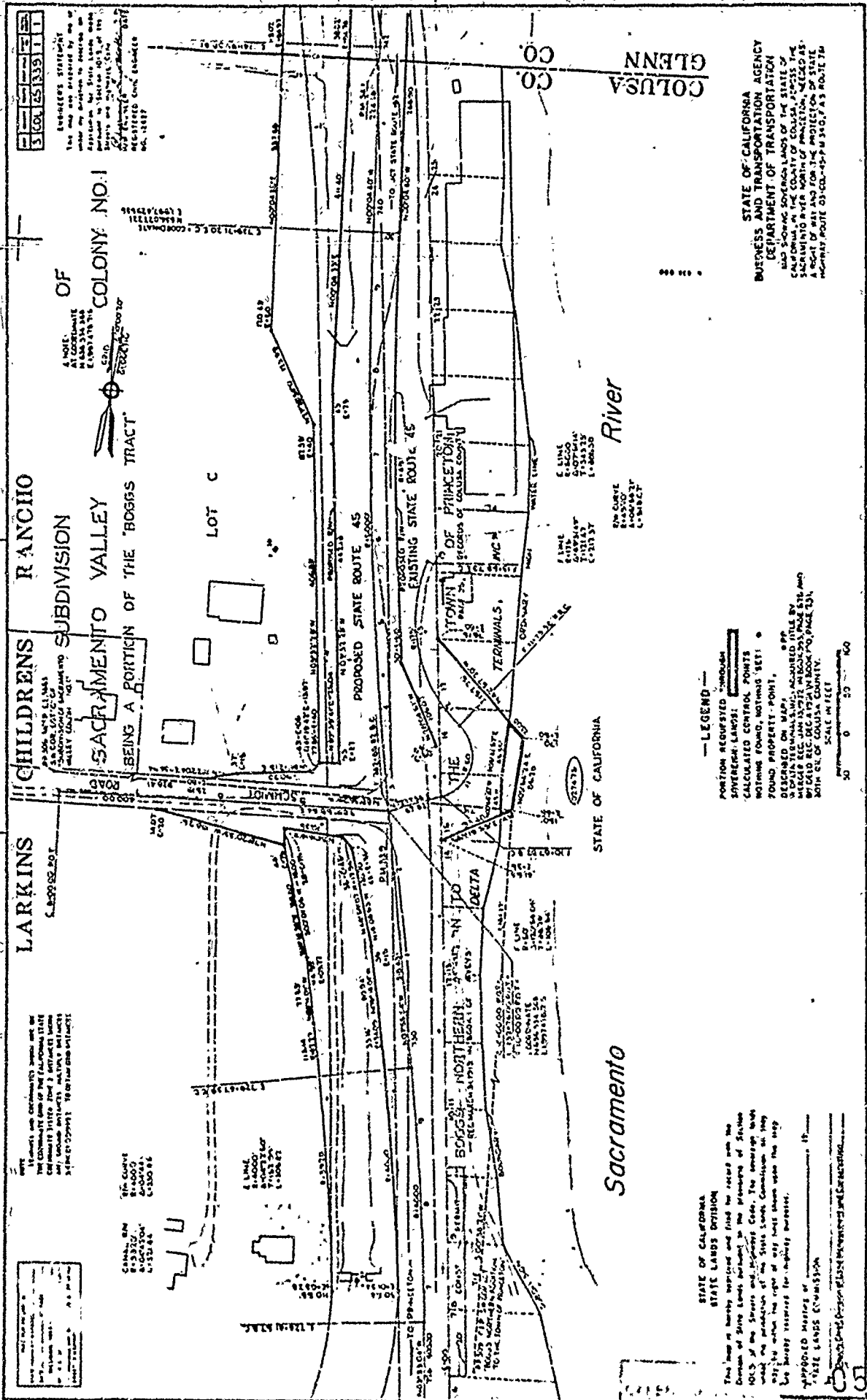

ENGINEERS STATEMENT
 This map was prepared by me or under my supervision and to the best of my knowledge and belief it conforms to all the requirements of the laws of this State relating to the preparation and filing of maps.

STATE OF CALIFORNIA
 BUSINESS AND TRANSPORTATION AGENCY
 DEPARTMENT OF TRANSPORTATION
 SAN FRANCISCO, CALIFORNIA
 RECEIVED AT THE OFFICE OF THE ENGINEER IN CHARGE OF THE STATE OF CALIFORNIA
 MAP NO. 1117

LEGEND

- PORTION REQUESTED THROUGH SOVEREIGN LANDS
- CALCULATED CONTROL POINTS
- NOTHING FOUND, NOTHING SET
- FOUND PROPERTY POINT
- DESCRIBED ON MAP
- A DATA TERMINAL SWELL, ALIGNED WITH THE CENTER OF THE RIVER CHANNEL, AS SHOWN ON THE 1854 ORIGINAL PLAT OF THE BOGGS TRACT, BOOK 301, PAGE 501, WITH EN. OF COLUSA COUNTY.
- SCALE IN FEET

1" = 100'

STATE OF CALIFORNIA
 STATE LANDS DIVISION

The map is hereby prepared and filed for record with the Division of State Lands pursuant to the provisions of Section 101.5 of the State Land Act, Chapter 659, Statutes of 1951, and the provisions of the State Lands Commission Act, Chapter 1229, Statutes of 1951, when the report of any land shown upon the map is hereby returned for public market.

APPROVED MAPS OF STATE LANDS COMMISSION

MINUTE PAGE

MINUTE PAGE W-21966 EXHIBIT 'A'

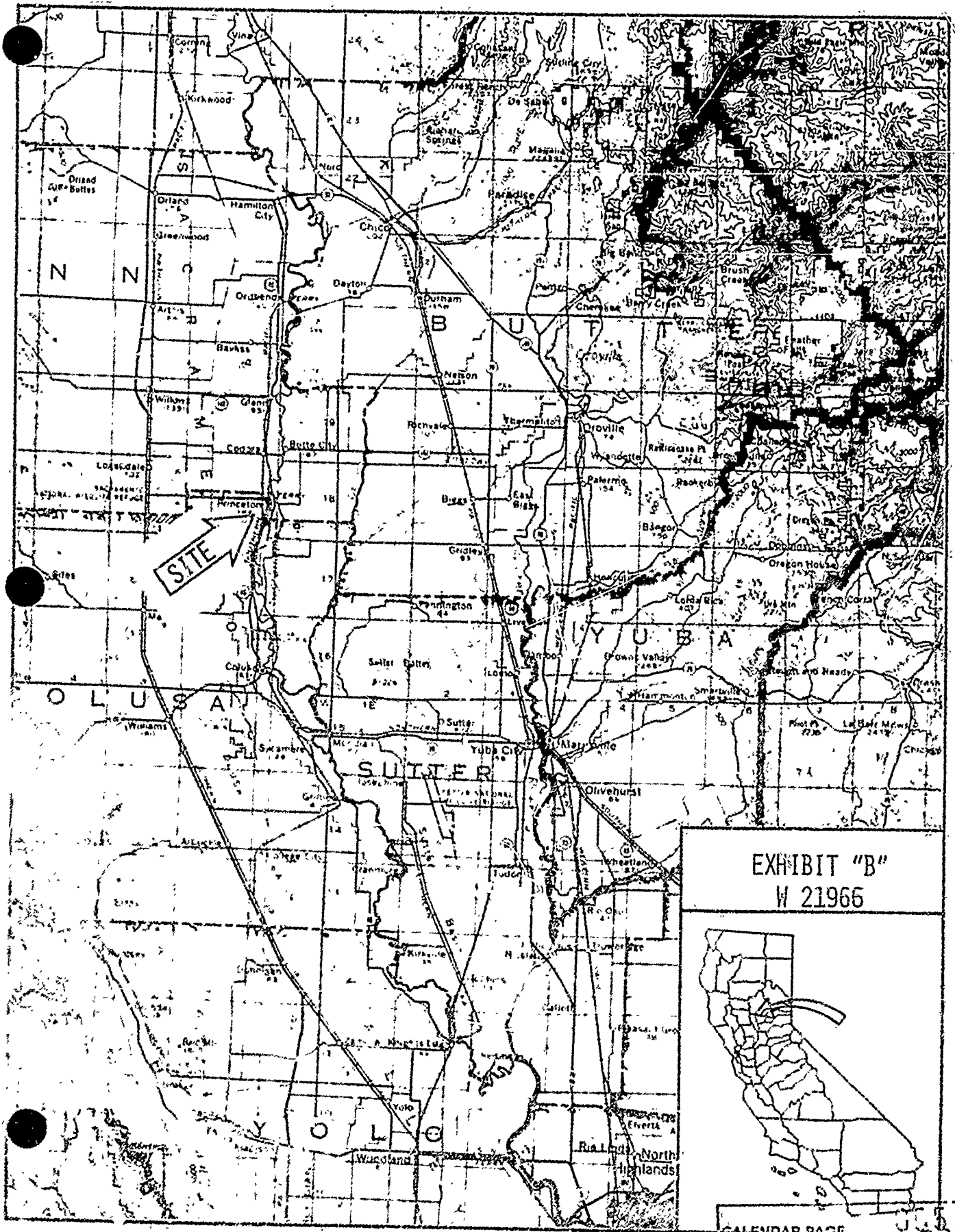

SITE

EXHIBIT "B"
W 21966



CALENDAR PAGE _____
 MINUTE PAGE _____

W 21966
EXHIBIT "C"

December, 1977

STATE OF CALIFORNIA
DEPARTMENT OF TRANSPORTATION

03-Co1, Gl'e-45
P.M. 33-8734.2; 0.0/3.1
03207 - 180301
SCH 76071243

NEGATIVE DECLARATION

Pursuant to: *Division 13 Public Resources Code (State).*

Description

It is proposed to widen and improve a 3.5-mile portion of Route 45 from the community of Princeton in Colusa County to Route 162 (E) in Glenn County. The existing highway will be widened from 22 feet (two 11-foot lanes) to 32 feet (two standard 12-foot lanes with 4-foot shoulders), and the horizontal alignment, cross slope, and public road connections will be improved.

This portion of Route 45 is a narrow two-lane levee road which traverses a rural agricultural area of the Sacramento Valley. The Sacramento River parallels the route and attracts some water-oriented recreational activities to the area.

This project is to increase safety and operational characteristics of an existing narrow highway with steep side slopes, some sharp curves, inadequate cross slopes, inadequate shoulders, and limited driver sight distance at intersections. Within a three-year period from 1974 to 1976, this portion of Route 45 has experienced 16 accidents, including three fatalities. The accident rate is 1 1/2 times as severe as the rate on adjacent portions of Routes 45 and 162. For the same three-year period the fatality rate is approximately six times the state-wide fatality rate for similar two-lane rural highways.

The proposed project will require the acquisition of approximately 15 acres and the relocation of approximately 4,500 feet of the Princeton-Codora-Glenn Irrigation District's River Branch Canal which parallels the highway.

Determination

It is determined that the proposed action will not have a significant effect upon the environment for the following reasons:

CALENDAR PAGE	056
MINUTE PAGE	701

1. Land use will not be altered and the effect on tax revenues will be insignificant. There are no residences or businesses to be acquired.
2. This safety project is not expected to alter the volume or composition of traffic.
3. No known parks, recreational areas, archaeological, or historical resources will be affected.
4. There will be no significant change in noise levels or air quality in the area.
5. Drainage patterns will remain unchanged and water quality will not be significantly affected.
6. The project will not significantly affect wildlife or its habitat in the area.
7. Disturbance of the surrounding terrain and vegetation will be minimal.



James R. Gordon
Chief, Environmental Planning

12/29/77
Date

CALENDAR PAGE	057
MINUTE PAGE	702

1416 Oak Street, Room 1311
Sacramento, CA 95814

SUBJECT: Filing of Notice in Compliance with Section 21103 of
the Public Resources Code

EXHIBIT "D"

W 21066

PROJECT DESCRIPTION

03-C01, G18-45

From Princeton to Route 162. Widen.

33.8/34.2, 0.0/3.1



SC# 007123

This is to advise you that the California Highway Commission has
made the following determinations regarding the above-described
project:

1. The project has been approved by the California Highway Commission.
 disapproved
2. The project will have a significant effect on the environment.
 will not
3. An Environmental Impact Report was prepared for this project pursuant
to the provisions of CEQA.
 A Negative Declaration was prepared for this project pursuant to the
provisions of CEQA. A copy of the Negative Declaration is attached.
 The project is an "on-going project" within the meaning of 15070(a)(1)
of the State Guidelines and does not require an EIR.

Submitted by the California Highway Commission this 19th day
of January, 1978.

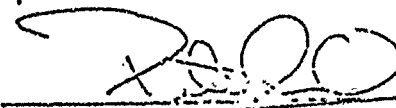
California Highway Commission
by



CALENDAR PAGE: 058
MINUTE PAGE: 703