

MINUTE ITEM

This Calendar Item No. C2  
was approved as Minute Item  
No. 2 by the State Lands  
Commission by a vote of 3  
to 0 at its 11/27/78  
meeting.

CALENDAR ITEM

C2.

11/78  
W 20366  
Scott  
PRC 5584

PUBLIC AGENCY PERMIT

APPLICANT: Department of Transportation  
Division of Highways  
1120 N Street  
Sacramento, California 95814

AREA, TYPE LAND AND LOCATION:  
A 3.35 + acre parcel of tide and submerged  
land in the bed of Steamboat Slough, Sacramento  
and Solano Counties.

LAND USE: An existing ferry crossing together with  
required warning lights on multiple pile  
dolphins upstream and downstream from the  
ferry crossing and underwater electric  
service to the warning lights.

TERM OF PROPOSED PERMIT:  
Period: Indefinite period from  
October 1, 1978.

CONSIDERATION: As set forth in Section 101.5, Streets  
and Highways Code.

BASIS FOR CONSIDERATION:  
Chapter 1052, Statutes of 1969.

PREREQUISITE TERMS, FEES AND EXPENSES:  
Applicant is owner of upland.

STATUTORY AND OTHER REFERENCES:  
A. P.R.C.: Div. 6, Parts 1 & 2.  
B. Cal. Adm. Code: Title 2, Div. 3.  
C. Streets and Highways Code, Section  
101.5.

OTHER PERTINENT INFORMATION:  
1. An EIR is not required. This transaction  
is within the purview of 2 Cal. Adm.  
Code 2907, Class 1(B), which exempts  
an existing structure or facility that  
is in an acceptable state of repair  
and there is no evidence of record  
to show injury to adjacent property,  
shoreline erosion, or other types of  
environmental degradation.

CALENDAR ITEM NO. C2. (CONTD)

2. This project is situated on State land identified as possessing significant environmental values pursuant to P.R.C. 6370.1, and is classified in a use category, Class B, which authorizes Limited Use.

Staff review indicates that there will be no significant effect upon the identified environmental values. This is an existing facility for which no adverse comments have been received.

3. The ferry has existed at this location for many years. It has been operated by the State since 1933. The installation of the warning lights for safety reasons is a minor modification to the existing facilities and was completed in 1972.

EXHIBITS:           A. 101.5 Plat.                   B. Location Map.

IT IS RECOMMENDED THAT THE COMMISSION:

1. DETERMINE THAT AN EIR HAS NOT BEEN PREPARED FOR THIS ACTIVITY AS SUCH REPORT IS NOT REQUIRED UNDER THE PROVISIONS OF P.R.C. 21085, 14 CAL. ADM CODE 15100 ET SEQ., AND 2 CAL. ADM. CODE 2907.
2. FIND THAT GRANTING OF THE PERMIT WILL HAVE NO SIGNIFICANT EFFECT UPON ENVIRONMENTAL CHARACTERISTICS IDENTIFIED PURSUANT TO SECTION 6370.1, OF THE P.R.C.
3. AUTHORIZE ISSUANCE TO THE DEPARTMENT OF TRANSPORTATION, PURSUANT TO SECTION 101.5 OF THE STREETS AND HIGHWAYS CODE, OF A PUBLIC AGENCY PERMIT FOR AN INDEFINITE PERIOD FROM OCTOBER 1, 1978; AND THE APPROVAL OF AN APPROPRIATE PLAT; IN CONSIDERATION OF THE MONETARY VALUE OF THE RIGHT-OF-WAY TO BE DEPOSITED IN THE GENERAL FUND FOR CREDIT TO THE RESOURCES PROTECTION ACCOUNT; FOR THE MAINTENANCE FOR HIGHWAY PURPOSES OF AN EXISTING FERRY AND WARNING LIGHT SYSTEM ON STATE SOVEREIGN LAND WITHIN THE HIGHWAY RIGHT-OF-WAY AS SHOWN ON MAPS NO. 10-SOL, SAC-220.

City	County	Sheet	Section	Block	Lot
10	SOL. SAC	220	30(SOL)	00(SAC)	

STATE OF CALIFORNIA  
STATE LANDS DIVISION  
THIS MAP IS HEREBY APPROVED AND FILED FOR RECORD WITH THE DIVISION OF STATE LANDS PURSUANT TO THE PROVISIONS OF SECTION 10.5 OF THE STREETS AND HIGHWAYS CODE. THE SOVEREIGN LANDS UNDER THE JURISDICTION OF THE STATE LANDS COMMISSION AS THEY MAY LIE WITHIN THE RIGHT OF WAY LINES SHOWN UPON THIS MAP ARE HEREBY RESERVED FOR HIGHWAY PURPOSES.

T. 5 N. R. 3 E. M.D.M.  
PROJ. SEC. 35

APPROVED MEETING OF \_\_\_\_\_, 19\_\_\_\_  
STATE LANDS COMMISSION  
BY \_\_\_\_\_  
TITLE \_\_\_\_\_

ENGINEER'S STATEMENT  
This map was prepared by me or under my direction to describe an Application for State Lands made pursuant to Section 10.5 of the Streets and Highways Code.  
John W. Walker, Jr. Engineer Date 12-13-77  
Registered Civil Engineer No. 27478

CROCKER CITIZENS NATIONAL BANK  
AND BIRDIE E. RASMUSSEN  
REC. 6-28-68  
VOL. 1514 - OR - PG. 212

RYER ISLAND  
SWAMP AND OVERFLOW SURVEY  
NO. 501  
AUGUSTO STEWART, A PARTNERSHIP  
REC. 10-7-75  
VOL. 1975 - OR - PG. 44050

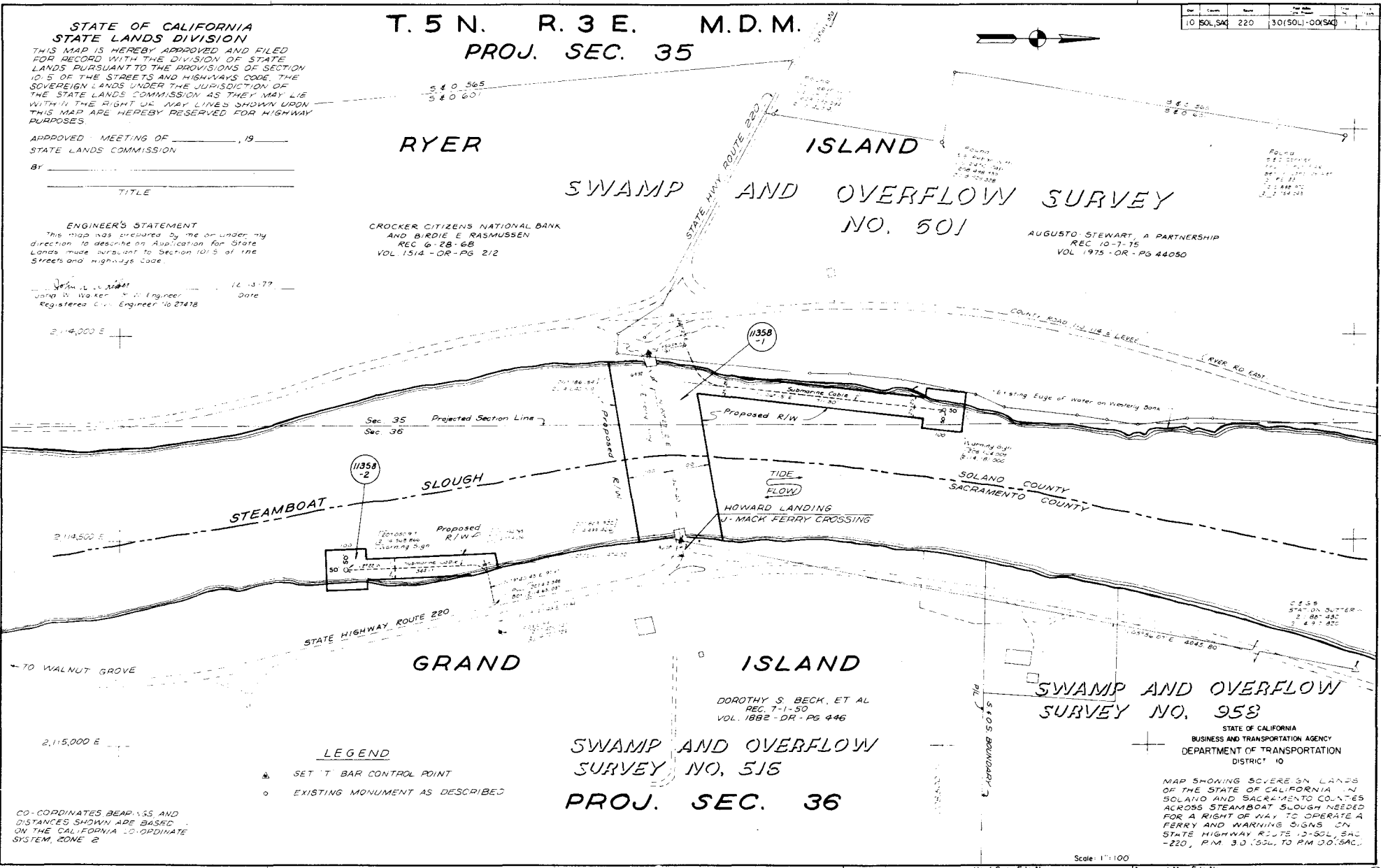

LEGEND  
▲ SET T BAR CONTROL POINT  
○ EXISTING MONUMENT AS DESCRIBED

SWAMP AND OVERFLOW SURVEY NO. 515  
PROJ. SEC. 36

DOROTHY S. BECK, ET AL  
REC. 7-1-50  
VOL. 1882 - DR - PG. 446

SWAMP AND OVERFLOW SURVEY NO. 958

STATE OF CALIFORNIA  
BUSINESS AND TRANSPORTATION AGENCY  
DEPARTMENT OF TRANSPORTATION  
DISTRICT 10

MAP SHOWING SOVEREIGN LANDS OF THE STATE OF CALIFORNIA IN SOLANO AND SACRAMENTO COUNTIES ACROSS STEAMBOAT SLOUGH NEEDED FOR A RIGHT OF WAY TO OPERATE A FERRY AND WARNING SIGNS ON STATE HIGHWAY ROUTE 13-SOL, SAC-220, P.M. 30(SOL) TO P.M. 30(SAC).

CO-ORDINATES BEARINGS AND DISTANCES SHOWN ARE BASED ON THE CALIFORNIA CO-ORDINATE SYSTEM, ZONE 2

Scale: 1"=100'

Hard Copy File No.

Appraisal Map File No.

W 20366 EXHIBIT A 2338

20366

SACRAMENTO 28 Mi. ↑

S  
L  
A  
N  
D

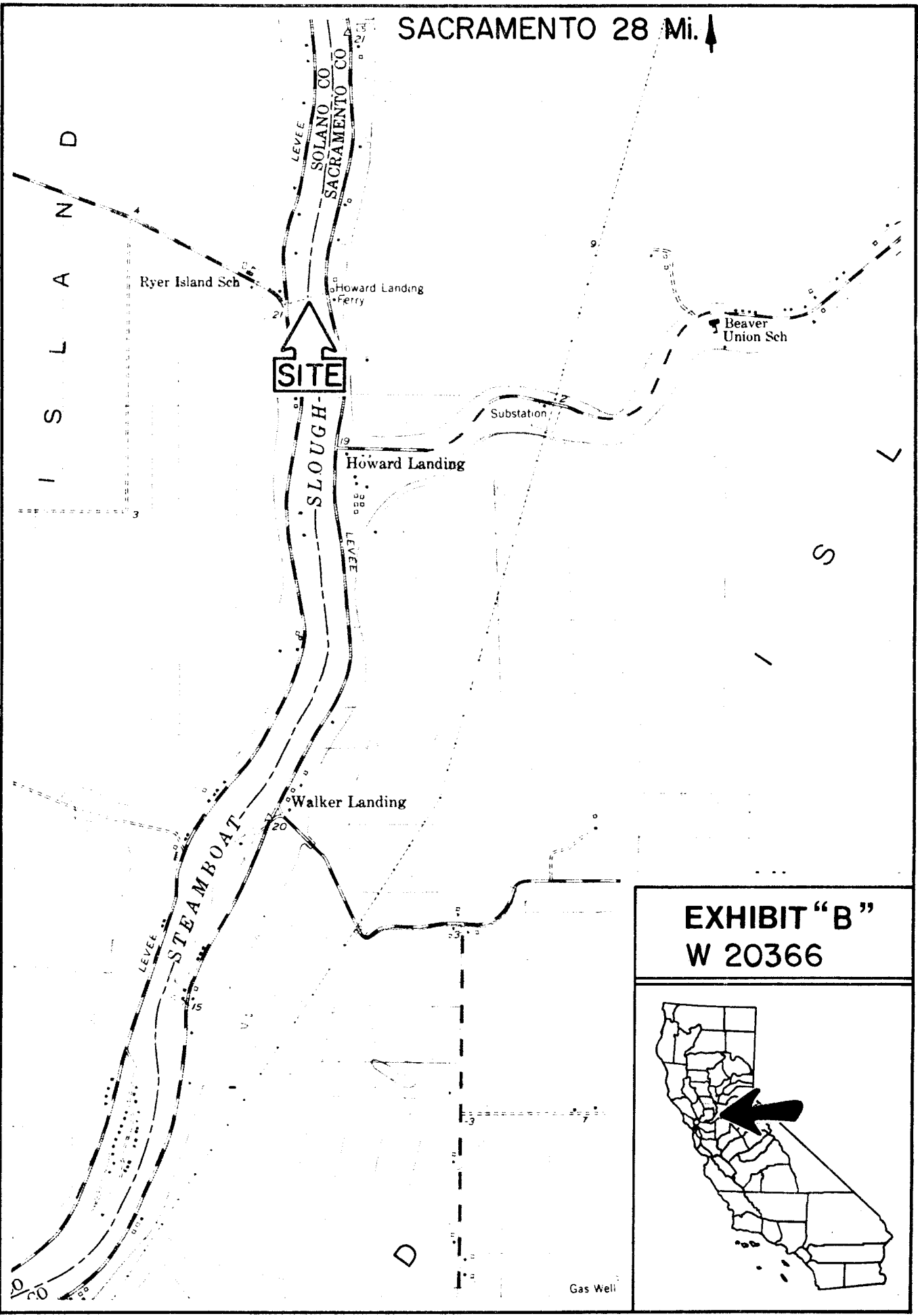

**EXHIBIT "B"**  
**W 20366**



Gas Well