

**STAFF REPORT
C18**

A 1
S 1

10/18/18
PRC 1617.1
S. Evans

REVISION OF RENT

LESSEE:

Peter F. Snook and Judith L. Snook, Trustees of the Snook Family Revocable Trust, dated April 11, 2000

AREA, LAND TYPE, AND LOCATION:

Sovereign land in Lake Tahoe, adjacent to 4688 North Lake Boulevard, near Carnelian Bay, Placer County.

AUTHORIZED USE:

Continued use and maintenance of a pier, boathouse with sundeck and stairs, boat lift, and two mooring buoys.

LEASE TERM:

10 years, beginning December 2, 2013.

CONSIDERATION:

This lease provides that the Commission may modify the rent periodically during the lease term. Pursuant to this provision, staff reviewed the rent under this lease and recommends that rent be revised from \$570 per year to \$910 per year, effective December 2, 2018.

OTHER PERTINENT INFORMATION:

1. On October 14, 2014, the Commission authorized a General Lease – Recreational Use to Peter F. Snook and Judith L. Snook, Trustees of the Snook Family Revocable Trust, dated April 11, 2000, for a term of 10 years beginning December 2, 2013 ([Item C10, October 14, 2014](#)). The lease will expire on December 1, 2023.
2. This action is consistent with Strategy 2.2 of the Commission's Strategic Plan to ensure timely receipt of revenues and royalties from the use and development of State lands and minerals.

STAFF REPORT NO. **C18** (CONT'D)

3. Approving the revision of rent is not a project as defined by the California Environmental Quality Act because it is an administrative action that will not result in direct or indirect physical changes in the environment.

Authority: Public Resources Code section 21065 and California Code of Regulations, title 14, section 15378, subdivision (b)(5).

EXHIBIT:

- A. Site and Location Map

RECOMMENDED ACTION:

It is recommended that the Commission:

AUTHORIZATION:

Approve the revision of rent for Lease No. PRC 1617.1 from \$570 per year to \$910 per year, effective December 2, 2018.

NO SCALE

SITE

APN 115-070-009

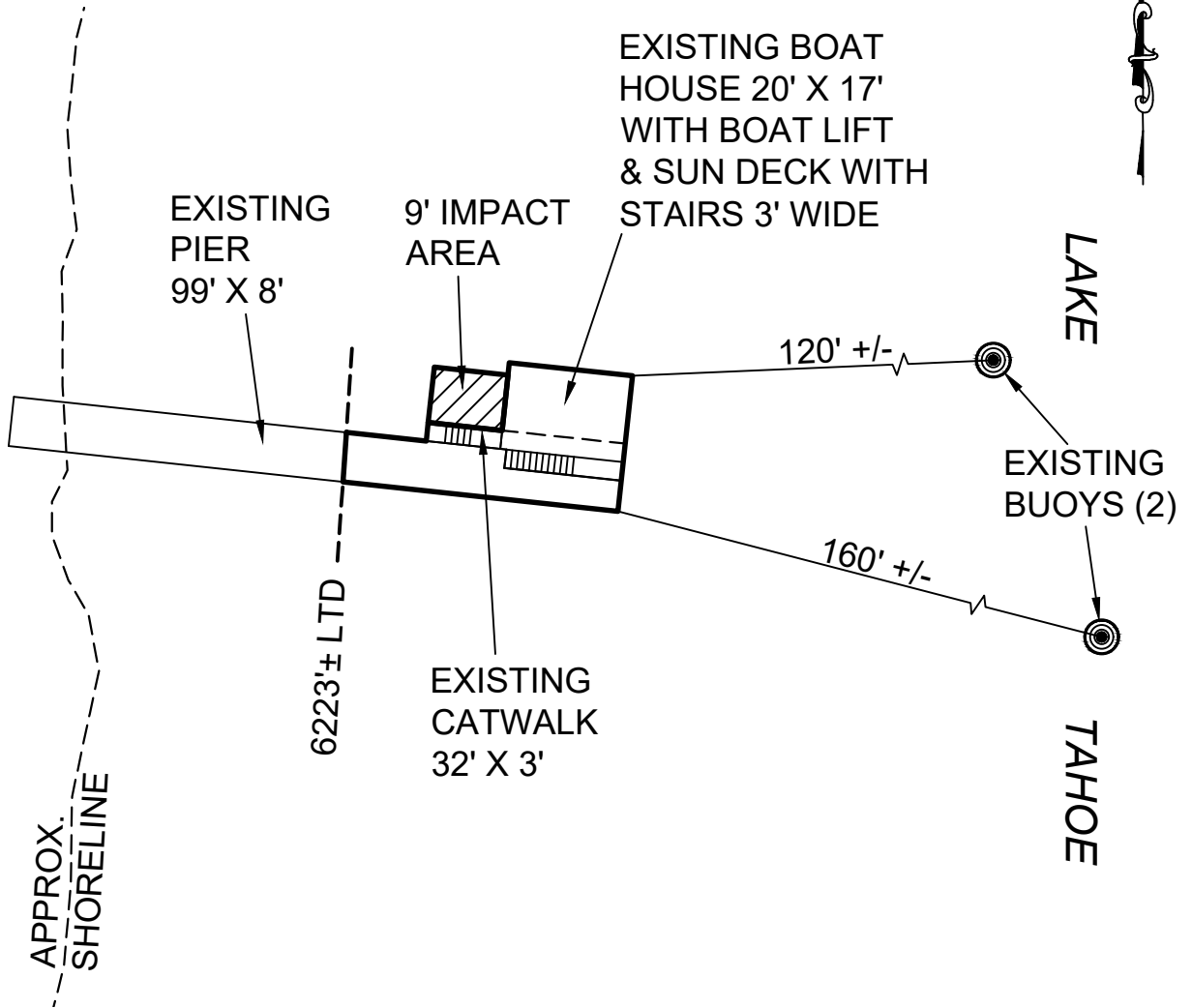

4688 NORTH LAKE BLVD., CARNELIAN BAY

NO SCALE

LOCATION



MAP SOURCE: USGS QUAD

This Exhibit is solely for purposes of generally defining the lease premises, is based on unverified information provided by the Lessee or other parties and is not intended to be, nor shall it be construed as, a waiver or limitation of any State interest in the subject or any other property.

Exhibit A

PRC 1617.1
 SNOOK
 APN 115-070-009
 GENERAL LEASE -
 RECREATIONAL USE
 PLACER COUNTY

SITE

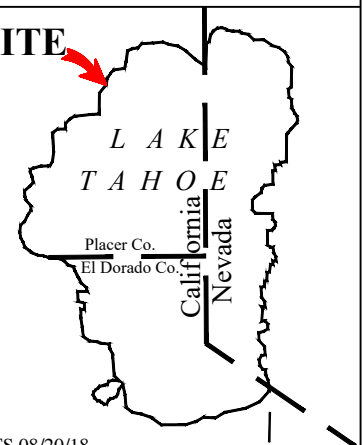

TS 08/20/18